

TO: Sarasota County School Board Members and Superintendent Lori White

FROM: Ernest Dubose, Project Manager

RE: Fruitville Addition

DATE: October 17, 2014

We have some time on your October 21, 2014 Workshop Agenda to discuss the project currently underway at Fruitville Elementary School. The attached documents are intended to support that conversation. The scope of the project is to build a classroom wing that will house the autism program at Fruitville and includes enough space to reduce their reliance on portables to zero—or as close to that as possible. The current budget for the project is \$7 million. What we want to discuss is a change in scope that will have a budgetary impact of about \$650,000. The additional funds are available in the unrestricted fund reserve of the Capital Budget.

The Fruitville Elementary Classroom Building Addition design process has revealed opportunities to significantly impact the students and staff at Fruitville Elementary beyond simply providing a new classroom building in place of the existing portables. Through communication and collaboration with our design team and school staff we've found there are three areas of improvement not in the original scope and/or budget of the project. These areas include building location, renovations to existing Building 8, and the addition of two parking lots. We present these items and their relative budget impacts to the Board for consideration.

The Location of the building will have a significant effect on the operations, education, safety, and security of students and staff. Throughout the initial stages of design, the team carefully considered the impacts of the building location. We considered three potential locations for the new building. The location within the current budget is shown on the attached site plan labeled Option B. This option sites the classroom addition near the extended bus loop—effectively behind the school. The preferred location (attached and labeled Option B.01) is more costly than the budgeted location primarily due to the need to relocate (demolish and construct) the existing covered pavilion play area and the paved basketball courts. The team is recommending the preferred location for several reasons. Locating the building within the existing confines of campus provides shorter travel distances for students and staff during day-to-day operations. More importantly this location allows for better supervision and improved safety—especially with students with autism. In the event of an incident, administrators and staff will be able to respond more quickly, particularly when approaching from the Administration Building, courtyard, or adjacent classroom buildings. Line of site supervision is also improved. Furthermore, this location provides functional inclusion as well as an atmosphere of inclusion for the Special Needs students that will occupy the building. This has been a cornerstone for the success of the program at Fruitville Elementary.

Financial Impact: \$243,734

The renovation of a portion of Building 8 would provide a functional and supplemental impact to the new classroom building. Building 8, as it exists today, would not functionally support the new building. Renovating approximately 4,300 square feet of the interior of the building would provide an Occupational Therapy Room, a Science Laboratory, and a classroom. Providing these spaces in Building 8 would create a better use of the existing space, provide better function, and be more cost effective than building these spaces in the new building. Its proximity to the proposed site of the new wing makes this the ideal location for these spaces.

Financial Impact: \$200,000

The third item of impact is adding two new parking lots, one in the southwest area of campus and the other at the extended bus loop. The addition of these parking lots would ease traffic jams by creating separate areas of parking, therefore diluting the amount of traffic impacting the school. This would also alleviate the school's dependency on the neighboring church for parking. There is currently an agreement with the church; however adding the two parking lots provides a permanent solution to this long-term concern.

Financial Impact: \$200,000

We feel that these three changes will dramatically impact the instruction, operation, and safety at Fruitville Elementary School and request the Board's consideration. We look forward to our discussion and answering any questions you may have.



Sawgrass Rd

Sawgrass Rd

Potter St

Honore Ave

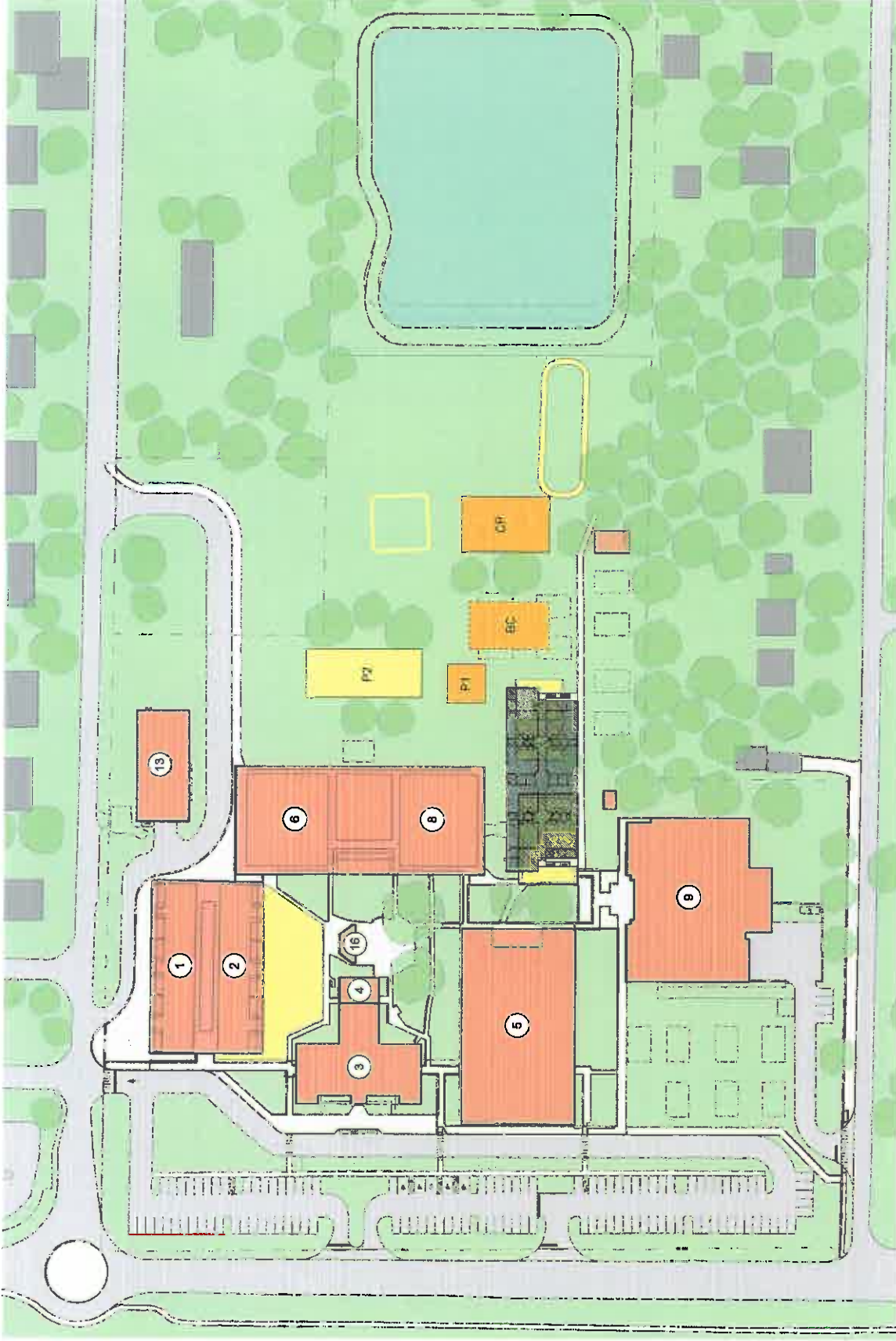

**Option B.01 Site Plan**

PORTABLE TO BE REMOVED  
AT PROJECT COMPLETION

- P1 - ESE PRE-K PLAYGROUND
- P2 - INTERMEDIATE PLAYGROUND
- CP - RELOCATED PLAY STRUCTURE
- BC - RELOCATED BASKETBALL COURT

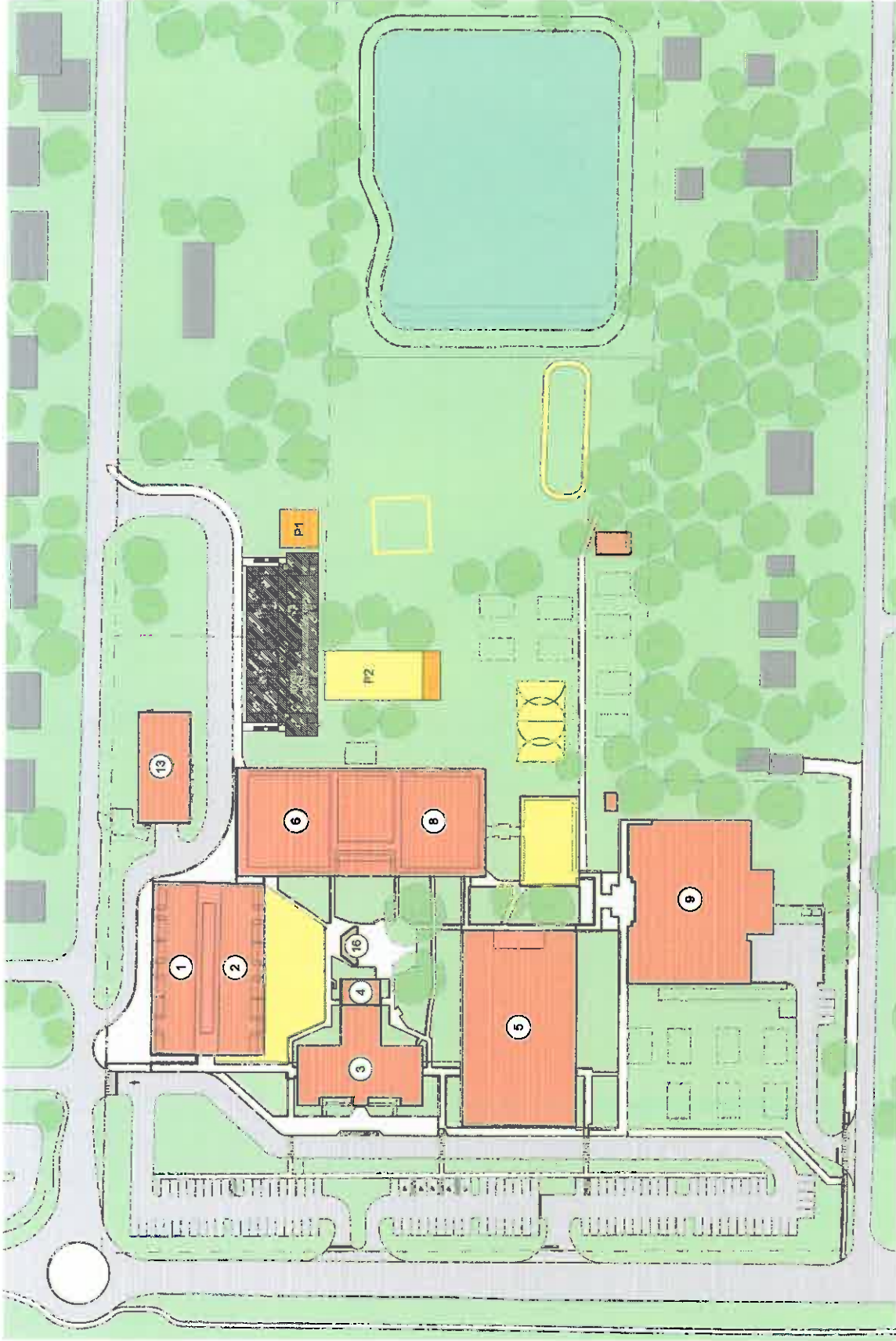

PORTABLE, TO BE REMOVED AT PROJECT COMPLETION

P1 - ESE PRE-K PLAYGROUND

P2 - INTERMEDIATE PLAYGROUND

## Option B Site Plan

# Fruitville ES Classroom Addition

School Board of Sarasota County

		Option B	Option B-01
Project Area (Square Feet)		26,044	26,044
Location		At Bus Loop (2 story)	Mid Campus (2 story)
DIV	Scope of Work	Total	Total
	<b>Classroom Addition Building</b>		
	<b>CONSTRUCTION SUBTOTAL</b>	\$ 4,865,984	\$ 5,424,930
	<b>TOTAL CM HARD COSTS WITH MARK-UPS</b>	\$ 5,781,476	\$ 6,385,209
	<b>Additional Items Contracted by Owner</b>		
	Relocate ESE Playground (Owner)		8,000
	Design Fees: Interior Renovations (Bldgs. 3 & 8)		32,000
	<b>Project Costs Contracted by Owner</b>		
	Design Fees	464,650	464,650
	Pre-Construction Fees	29,000	29,000
	Miscellaneous Soft Costs & Contingency	292,074	292,074
	<b>TOTAL OWNER CONTRACTED COSTS</b>	\$ 785,724	\$ 825,724
	<b>TOTAL PROJECT BUDGET</b>	\$ 6,567,200	\$ 7,210,933

<b>Additional Scope of Project</b>			
Difference Between Option A & Option B-01			\$ 243,734
Building 8 Renovations			\$ 200,000
Parking Lot Additions (both)			\$ 200,000
<b>TOTAL ADDITIONAL COSTS</b>			\$ 643,734